

CITY OF
BAYARD Nebraska



**ONE (1) & SIX (6) YEAR
STREET IMPROVEMENT PROGRAM**

**2026
2026 – 2031**

Prepared by: Jeff Wolfe (S-1025)
M.C. Schaff & Associates
818 South Beltline Hwy E.
Scottsbluff, NE 69361

GENERAL

The City of Bayard completed project M-137(52) during the 2025 calendar year. The City of Bayard also perform normal maintenance on the city streets during the 2025 calendar year.

The City plans to complete project M-137(57) and perform normal maintenance during the 2026 calendar year.

ONE YEAR PLAN

M-137(57) - Remove and replace pavement, curb, and gutter on 2nd Avenue from 4th Street to 5th Street (\$350,000).

SIX YEAR PLAN

M-137(36c) - Construct asphalt overlay on 1st Avenue from 5th Street to 6th Street (\$100,000).

M-137(51) - Seal Coat Ave A from 10th St. to 11th St (\$30,000).

M-137(7) - Construct intersections at Avenue B and 3rd Street, and Avenue B and 4th Street (\$160,000).

M-137(9) - Construct curb and gutter on Avenue A from 2nd Street to 4th Street and on Avenue B, from 3rd Street to 5th Street (\$200,000).

M-137(22) - Construct curb, gutter and pavement on 3rd Street from Avenue A to Avenue B (\$350,000).

M-137(48) - Construct curb, gutter and pavement on 13th Street from Main Street to Avenue C (\$350,000).

M-137(49) - Construct curb, gutter and pavement on 14th Street from Main Street to Avenue C (\$350,000).

M-137(50) - Construct ADA access intersections Citywide (\$75,000).

M-137(53) - Reconstruct 8th Street from Main to 1st Avenue (\$350,000).

M-137(54) - Reconstruct intersection at 6th Street and 1st Avenue (\$300,000).

M-137(55) - Reconstruct 5th Street from Avenue A to Avenue B (\$350,000).

M-137(56) - Reconstruct Avenue B from 5th Street to 6th Street
(\$350,000).

The Mayor and City Council of the City of Bayard, County Morrill, State of Nebraska, met in a regular rescheduled session in the Council Chambers November 18, 2025 after November 11, 2025 meeting did not have quorum. City of Bayard, 445 Main Street, Bayard, Nebraska, 69334. Notice of the original meeting having been published in the Bayard Transcript on November 5, 2025. Notice of the rescheduled session was posted in three places in town. An agenda for the meeting was made available to the Mayor and each of the Council Members prior to the meeting. Present was Mayor Scot Ouderkirk and Council Members: Chris Baird, Garrett Schukei, Jamie Hernandez, and Diane Kraus. Absent Tanner Henkel and Marty Marquez. There being a quorum of council members present, Mayor Ouderkirk called the meeting to order at 6:00 P.M. The Pledge of Allegiance was recited. Mayor Ouderkirk presided over the meeting and noted that a copy of the Open Meetings Act is located in City Council Chambers and available to the public. City Clerk/Treasurer Bowlin recorded the minutes.

APPROVAL OF AGENDA

Council member Baird made a motion to approve the agenda with the addition of emergency items about LB840 money. Seconded by council member Kraus. ROLL CALL: AYES: Baird, Hernandez, Kraus and Schukei. NAYS: None. Motion declared carried by Mayor Ouderkirk.

PUBLIC HEARING

Mayor Ouderkirk opened the Public Hearing for the 1- & 6-Year Street Plan at 6:06 P.M.

The purpose of the hearing is to propose to the residents of the City, One (1) Year definite street improvement and Six (6) Year tentative street improvements. In compliance with Section 39-2115 and 39-2119 of Chapter 39 of the Cumulative Supplement of the Revised Statutes of Nebraska.

City Clerk Bowlin explained the minor changes that were added. After no other public comment, the hearing was closed at 6:11 P.M.

Council member Kraus moved to approve Resolution #1056 for final approval of the 1- & 6-Year Street Improvement Plan. Seconded by Council Member Schukei. ROLL CALL: AYES: Hernandez, Kraus, Schukei, and Baird. NAYS: None. Motion declared passed by Mayor Ouderkirk.

RESOLUTION 1057

Council member Baird moved to approve Resolution 1057 to approve having Home for the Holidays parade on December 5th at 6 PM in conjunction with the Soup Supper. Seconded by council member Hernandez. ROLL CALL: AYES: Kraus, Schukei, Baird, and Hernandez. NAYS: None. Motion declared carried by Mayor Ouderkirk.

CITY OF BAYARD SIGN BY CHIMNEY ROCK

Council member Kraus moved to approve entering into a contract with Randy Eirich to place a sign advertising Bayard out by Chimney Rock Visitor Center. Seconded by council member Hernandez. ROLL CALL: AYES: Schukei, Baird, Hernandez, and Kraus. NAYS: None. Motion declared carried by Mayor Ouderkirk.

CITY BILLS & CLAIMS

Council member Baird moved to approve all city bills and claims in the amount of \$298,579.46. Seconded by council member Kraus. ROLL CALL: AYES: Baird, Hernandez, Kraus, and Schukei. NAYS: None. A&A Porta Potties \$300.00, Aflac \$1,633.80, Airgas \$11.75, AST \$53.90, Amazon \$449.23, AT&T \$380.66, Bayard Automotive \$123.89, Benzel \$99.00, Black Hills Energy \$620.95, Border States \$42.26, Capital Business Systems \$217.40, CenturyLink \$59.67, Charter \$816.63, Chimney Rock PPD \$126.98, Chimney Rock Villa- UHC \$19,475.63, City of Gering \$12,489.41, Civic Plus \$1,323.00, Collaborate Summer Reading \$565.74, Connecting Point \$85.83, Contractors \$250.00, Credit Mgmt \$448.23, Croell \$1,597.75, Culligan \$238.00, Deere Financial \$422.15, Dollar General \$40.00, Douglas Kelly Ostdiek \$1,057.25, Zak Douglass \$74.43, Enviro Service \$60.00, Equitable \$1,503.36, Fox Insurance \$1,288.00, General Consolidated \$197.88, GreatAmerica \$149.99, Hawkins \$1,515.00, Ideal Linen \$269.51, Ingram \$1,822.83, Intralinks \$1,213.99, John Hancock \$1,596.58, Kuskie \$2,129.24, LARM \$1,568.28, Lincoln Life \$124.71, Menards \$603.02, Midwest Salt \$6,558.02, Morrill Co Attorney \$150.00, Morrill Co Hospital \$1,000.00, Morrill Co Sheriff \$2,500.00, MEAN \$32,700.53, Municipal Supply \$250.25, NLC \$500.00, NMCA \$100.00, North Central Emergency \$70,750.00, NW Pipe \$617.60, NWEA \$230.00, Gaytha Oldaker \$57.12, Print Works \$554.39, PT Hose \$103.24, Rocky Mtn. Air \$194.40, Scb Building & Zoning \$266.00, Star Herald \$218.40, Titan \$62,000.00, Transcript \$767.94, TCD \$750.00, US Bank \$3,684.62, Viaero \$27.29, WY First Aid \$94.91, Payroll \$57,428.79. Motion declared carried by Mayor Ouderkirk.

CHIMNEY ROCK VILLA

Council member Hernandez moved to approve the Chimney Rock Villa Bills & Claims as presented in the amount of \$261,379.72. Seconded by council member Schukei. ROLL CALL: AYES: Hernandez, Kraus, Schukei, and Baird. NAYS: None. Motion declared carried by Mayor Ouderkirk.

HEALTH INSURANCE RENEWAL

Council member Schukei made a motion to approve staying with United Healthcare for Health Insurance and Equitable for Dental, Vision and Life Insurance; keeping the City and Villa combined. Seconded by council member Hernandez. ROLL CALL: AYES: Kraus, Schukei Baird, and Hernandez. NAYS: None. Motion declared carried by Mayor Ouderkirk.

DEPARTMENT HEAD MONTHLY REPORTS

All department heads gave their reports.

- **UTILITY REPORT** – replaced many street lights, installed little libraries, cut trees out of power lines, replaced signs, repaired street and curb, working on cleaning storm drains.
- **POLICE REPORT** – 34 assist the public, 7 assist other agencies, 1 accident investigations, 5 citation violations, 19 warning violations, 8 complaints, and 1 investigation.
- **LIBRARY REPORT** – There were 700 books checked out in the month of October, the computer was used 19 times, 169 books checked out through Overdrive; submitted three NLC grants; will be picking four names from Christmas giving trees; new adult book bingo to start, little libraries have been installed.
- **OFFICE REPORT** – Monthly reports, payroll, Meetings, working with Auditors, Utility Rate Changes, LB840.
- **PARKS** – Done for the season, turned off water at parks and ballfields, winterized concession stand.

CONSENT AGENDA

Council member Kraus moved to approve the consent agenda which included minutes from October 14th meeting; Treasurer's reports, operational budget and Fire Department minutes from October. Seconded by council member Baird. ROLL CALL: AYES: Schukei, Baird, Hernandez, and Kraus. NAYS: None. Motion declared carried by Mayor Ouderkirk.

STREET SWEEPER

Council member Schukei made a motion to approve a five-year lease for a new street sweeper. Seconded by council member Hernandez. ROLL CALL: AYES: Baird, Hernandez, Kraus and Schukei. NAYS: None. Motion declared carried by Mayor Ouderkirk.

ORDINANCE 891

Council member Schukei introduced Ordinance 891 amending Garbage Rates effective January 1, 2026. City Clerk Bowlin read the title.

AN ORDINANCE OF THE CITY OF BAYARD, NEBRASKA AMENDING SECTION 51.04 OF THE CITY CODE CONCERNING SERVICE RATES FOR GARBAGE COLLECTION; PROVIDING FOR REPEAL OF CONFLICTING ORDINANCES; AND PROVIDING FOR EFFECTIVE DATE OF THIS ORDINANCE.

EMPLOYEE RECOGNITION

Council member Baird made a motion to host Employee Recognition dinner at the American Legion on January 24th with Happy Hour starting at 5 PM with dinner to follow at 6 or 6:30 PM. Seconded by council member Schukei. ROLL CALL: AYES: Hernandez, Kraus, Schukei, and Baird. NAYS: None. Motion declared carried by Mayor Ouderkirk.

BONUSES

Council member Kraus moved to approve incentive bonuses for city employees of \$150 for full-time, \$100 for part-time, and \$75 for casual or less than 90 days. Seconded by council member

Schukei. ROLL CALL: AYES: Kraus, Schukei, Baird, and Hernandez. NAYS: None. Motion declared carried by Mayor Ouderkirk.

Council member Hernandez moved to approve incentive bonuses for Chimney Rock Villa employees of \$150 for full-time, \$100 for part-time, and \$75 for casual or less than 90 days. Seconded by council member Schukei. ROLL CALL: AYES: Schukei, Baird, Hernandez, and Kraus. NAYS: None. Motion declared carried by Mayor Ouderkirk.

ADDED EMERGENCY ITEMS FOR LB840

Council member Baird made a motion accept agreement with Jeremy Serda (Kenworth of the Rock) for payoff of LB840 grant/loan in the amount of \$15,000.00. Seconded by council member Schukei. ROLL CALL: AYES: Baird, Hernandez, Kraus, and Schukei. NAYS: None. Motion declared carried by Mayor Ouderkirk.

Council member Hernandez made a motion accept agreement with Josh Schwartzkopf for payoff of LB840 grant/loan in the amount of \$12,265.00. Seconded by council member Baird. ROLL CALL: AYES: Hernandez, Kraus, Schukei, and Baird. NAYS: None. Motion declared carried by Mayor Ouderkirk.

PUBLIC COMMENT

None.

ADJOURNMENT

Council member Schukei moved to adjourn at 7:18 P.M. Seconded by council member Hernandez. ROLL CALL: AYES: Schukei, Kraus, Hernandez, and Baird. NAYS: None. Meeting declared adjourned by Mayor Ouderkirk.

S Ouderkirk.
Mayor

S Bowlin
City Clerk/Treasurer

RESOLUTION #1056

TO WHOM IT MAY CONCERN:

At the regular meeting of the City Council of the City of Bayard, Nebraska, held in the City Hall on November 18, 2025, a hearing was held on the One (1) and Six (6) Year Street Improvement Program at 7:00 P.M., as advertised. Following a discussion by the City Council and citizens present, a motion was made to adopt the One (1) and Six (6) Year Street Improvement Program for the calendar year 2026. Roll call vote brought:” Yeas, 4; “Nays”, 0. Motion carried.

CERTIFICATION

I, the undersigned, duly qualified and acting Clerk of the City of Bayard, Nebraska, do hereby certify that the above is a true and certified copy of action passed on November 18, 2025, and I officially affix my signature and the seal of said City on this 18th day of November, 2025.



Scot Ouderkirk, Mayor



Shelly Bowlin - City Clerk

NOTICE OF PUBLIC HEARING

A public hearing on the One (1) and Six (6) year Street Improvement Program for the City of Bayard, Nebraska, will be held in the City Office Meeting Room at 7:00 P.M., November 11, 2025. The purpose of the hearing is to propose to the residents of the City, One (1) Year Definite Street Improvement and Six (6) Year Tentative Street Improvement Program in compliance with Section 39-2115 and 39-2119 of Chapter 39 of the Cumulative Supplement of the Revised Statutes of Nebraska, 1943.

Copies of the proposed One (1) and Six (6) Year Street Improvement Programs may be studied in the office of the City Clerk.

Shelly Bowlin -Bayard City Clerk

Published **October XX, 2025**

November 11, 2025

State of Nebraska
Department of Roads
Board of Classifications & Standards
P.O. Box 94759
Lincoln, NE 68509-4759

RE: One (1) & Six (6) Year Street Improvement Program
Bayard, Nebraska (M-137)

CERTIFICATION

I, Jeff Wolfe, the Street Superintendent for the City of Bayard, Nebraska, do hereby certify that I posted the "Notice for Public Hearing" for the Proposed One (1) and Six (6) Year 2026 Street Improvement Program in three (3) public places within the City limits of Bayard, Nebraska:

Bayard City Office
445 Main Street

Bayard Post Office
517 Main Street

FNBO
302 Main Street

DATED this 11th day of November, 2025.

Signed: *Jeff Wolfe*
Jeff Wolfe
Street Superintendent #1025

One- And Six-Year Plan Highway, Road or Street Improvement Work/Project

GENERAL INFO	Name (County or Municipality): Bayard <input checked="" type="checkbox"/> Existing W/P <input type="checkbox"/> New W/P <input type="checkbox"/> Revision W/P							
	Work/Project (W/P) Number: M-137 (7)		Work/Project Length: 200.00		feet			
	Other Work/Project Number:				Control Number:			
	Interlocal Agreement: <input type="checkbox"/> Yes <input checked="" type="checkbox"/> No If Yes, Name of Other Entity:							
REVISIONS	Location Intersection of Avenue B and 3rd Street. Intersection of Avenue B and 4th Street. Install new							
	Description: PCC pavement, curb, gutter, and walks.							
STDS	If Revision, describe the changes:							
	Notification of Revision of One-Year Plan? <input type="checkbox"/> Yes <input type="checkbox"/> No If Yes, what is the reason? <input type="checkbox"/> Revisions to the Work/Project <input type="checkbox"/> Emergency Work/Proj Needed <input type="checkbox"/> Additional Funding Available <input type="checkbox"/> Other: _____							
TRAFF SPD	Functional Class National: Local State: Local							
	Design Standards Table 2-001. 03. F		National Highway System: <input type="checkbox"/> Yes <input checked="" type="checkbox"/> No					
ROADWAY	Design Speed: 25 MPH		Posted/Anticipated Speed = 25 MPH					
	Avg Daily Traffic :		Initial Year 2018	VPD 100	Hvy Trucks % 5	Design Year 2050	VPD 200 Hvy Trucks % 5	
BRIDGES & STRUCTURES	HIGHWAY, ROAD OR STREET		EXISTING		PROPOSED IMPROVEMENT			
			Surface Type	Width (ft)	Surface Type	Thickness (in)	Width (ft)	Work Type
ANALYSES	Traveled Way:		Gravel	Varies	Concrete	6	Varies	N&R
	Shoulders:		Earth	Varies	Concrete	6	Varies	
OTHER SCOPE	BRIDGES AND STRUCTURES		EXISTING		PROPOSED IMPROVEMENT			
	Structure Number(s) City/County - NBIS		Structure Type	Condition SR SD FO	Structure Type	Size	Design Loading and Work Type	
FINANCIAL	Other Scope of Work:		<input checked="" type="checkbox"/> Grading	<input type="checkbox"/> Acquire Right of Way	<input type="checkbox"/> Remove Existing Bridge/Structure			
	<input type="checkbox"/> Add Auxiliary Lane(s)		<input type="checkbox"/> Guardrail	<input type="checkbox"/> Other Utilities Work	<input type="checkbox"/> Bridge Re-deck			
FINANCIAL	<input type="checkbox"/> Sidewalk/Trail		<input type="checkbox"/> Fencing	<input type="checkbox"/> Lighting	<input type="checkbox"/> Bridge Rail			
	<input type="checkbox"/> Removal of Roadside Obstacles		<input checked="" type="checkbox"/> Curb Work	<input type="checkbox"/> Traffic Control Devices	<input type="checkbox"/> Storm Sewer or Culverts			
FINANCIAL	<input type="checkbox"/> Flatten Vertical Curve(s)		<input checked="" type="checkbox"/> Curb Ramp(s)	<input type="checkbox"/> Construction Detour	<input type="checkbox"/> Erosion Control			
	<input type="checkbox"/> Other: _____							
FINANCIAL	Drainage Study Completed for Structures/Drainage Facilities <input type="checkbox"/> Yes <input type="checkbox"/> Pending <input checked="" type="checkbox"/> N/A				Work/Project Relaxation of Standards Requested <input type="checkbox"/> Yes <input type="checkbox"/> Pending <input checked="" type="checkbox"/> N/A			
	Analyses Completed: <input type="checkbox"/> Yes <input type="checkbox"/> Pending <input checked="" type="checkbox"/> N/A				Other Benefit/Cost Analysis <input type="checkbox"/> Yes <input type="checkbox"/> Pending <input checked="" type="checkbox"/> N/A			
FINANCIAL	Nebraska licensed engineer providing design and construction phases services: <input checked="" type="checkbox"/> Yes <input type="checkbox"/> No							
	Construction Period (estimated): 60.0 working days							
FINANCIAL	Other Funds to be Applied:		<input type="checkbox"/> Federal Fund Purchase Program	<input type="checkbox"/> State-Aid Bridge Fund	<input type="checkbox"/> Federal Funds thru NDOR			
	<input type="checkbox"/> LB960 County Bridge Match Program		<input type="checkbox"/> State Recreation Road Fund	<input type="checkbox"/> Other: _____				
FINANCIAL	Estimated Costs (1,000)		County	Municipality	State	Federal	Other	Total
				160				
FINANCIAL	Print Name: Jeff Wolfe		Title: City Street Superintendent		Date: 11/11/2025			
	Signature: <i>Jeff Wolfe</i>							

One- And Six-Year Plan Highway, Road or Street Improvement Work/Project

GENERAL INFO	Name (County or Municipality): Bayard <input checked="" type="checkbox"/> Existing W/P <input type="checkbox"/> New W/P <input type="checkbox"/> Revision W/P						
	Work/Project (W/P) Number: M-137 (9)		Work/Project Length: 0.50 miles				
	Other Work/Project Number:				Control Number:		
	Interlocal Agreement: <input type="checkbox"/> Yes <input checked="" type="checkbox"/> No If Yes, Name of Other Entity:						
REVISIONS	Location Avenue A from 2nd Street to 4th Street. Avenue B from 3rd Street to 5th Street. Install new						
	Description: curb, gutter, and grading						
STDS	If Revision, describe the changes:						
	Notification of Revision of One-Year Plan? <input type="checkbox"/> Yes <input type="checkbox"/> No If Yes, what is the reason? <input type="checkbox"/> Revisions to the Work/Project <input type="checkbox"/> Emergency Work/Proj Needed <input type="checkbox"/> Additional Funding Available <input type="checkbox"/> Other: _____						
TRAFFIC	Functional Class National: Local State: Local						
	Design Standards Table 2-001. 03. F		National Highway System: <input type="checkbox"/> Yes <input checked="" type="checkbox"/> No				
ROADWAY	Design Speed: 25 MPH		Posted/Anticipated Speed = 25 MPH				
	Avg Daily Traffic :	Initial Year 2018	VPD 200	Hvy Trucks % 5	Design Year 2050	VPD 400	Hvy Trucks % 5
BRIDGES & STRUCTURES	HIGHWAY, ROAD OR STREET		EXISTING		PROPOSED IMPROVEMENT		
	Traveled Way:	Surface Type Gravel	Width (ft) Varies	Surface Type Gravel	Thickness (in) 6	Width (ft) Varies	Work Type N&R
	Shoulders:	Earth	Varies	Concrete	6	Curbed	
OTHER SCOPE	BRIDGES AND STRUCTURES		EXISTING		PROPOSED IMPROVEMENT		
	Structure Number(s) City/County - NBIS		Structure Type	Condition SR SD FO	Structure Type	Size	Design Loading and Work Type
				____ <input type="checkbox"/> <input type="checkbox"/>			
				____ <input type="checkbox"/> <input type="checkbox"/>			
ANALYSES	Other Scope of Work:			<input checked="" type="checkbox"/> Grading <input type="checkbox"/> Acquire Right of Way <input type="checkbox"/> Remove Existing Bridge/Structure <input type="checkbox"/> Add Auxiliary Lane(s) <input type="checkbox"/> Guardrail <input type="checkbox"/> Other Utilities Work <input type="checkbox"/> Bridge Re-deck <input type="checkbox"/> Sidewalk/Trail <input type="checkbox"/> Fencing <input type="checkbox"/> Lighting <input type="checkbox"/> Bridge Rail <input type="checkbox"/> Removal of Roadside Obstacles <input checked="" type="checkbox"/> Curb Work <input type="checkbox"/> Traffic Control Devices <input type="checkbox"/> Storm Sewer or Culverts <input type="checkbox"/> Flatten Vertical Curve(s) <input checked="" type="checkbox"/> Curb Ramp(s) <input type="checkbox"/> Construction Detour <input type="checkbox"/> Erosion Control <input type="checkbox"/> Other: _____			
	Drainage Study Completed for Structures/Drainage Facilities <input type="checkbox"/> Yes <input type="checkbox"/> Pending <input checked="" type="checkbox"/> N/A			Work/Project Relaxation of Standards Requested <input type="checkbox"/> Yes <input type="checkbox"/> Pending <input checked="" type="checkbox"/> N/A			
FINANCIAL	Analyses Completed: <input type="checkbox"/> Yes <input type="checkbox"/> Pending <input checked="" type="checkbox"/> N/A			Cost Effective Analysis <input type="checkbox"/> Yes <input type="checkbox"/> Pending <input checked="" type="checkbox"/> N/A			
	Other Benefit/Cost Analysis <input type="checkbox"/> Yes <input type="checkbox"/> Pending <input checked="" type="checkbox"/> N/A						
Nebraska licensed engineer providing design and construction phases services: <input checked="" type="checkbox"/> Yes <input type="checkbox"/> No							
Construction Period (estimated): 60.0 working days							
Other Funds to be Applied: <input type="checkbox"/> Federal Fund Purchase Program <input type="checkbox"/> State-Aid Bridge Fund <input type="checkbox"/> Federal Funds thru NDOR <input type="checkbox"/> LB960 County Bridge Match Program <input type="checkbox"/> State Recreation Road Fund <input type="checkbox"/> Other: _____							
Estimated Costs (1,000)		County	Municipality	State	Federal	Other	Total
			200				200
Print Name: Jeff Wolfe			Title: City Street Superintendent		Date: 11/11/2025		
Signature: <i>Jeff Wolfe</i>							

One- And Six-Year Plan Highway, Road or Street Improvement Work/Project

GENERAL INFO	Name (County or Municipality): Bayard <input checked="" type="checkbox"/> Existing W/P <input type="checkbox"/> New W/P <input type="checkbox"/> Revision W/P						
	Work/Project (W/P) Number: M-137 (22)		Work/Project Length: 300.00		feet		
	Other Work/Project Number:				Control Number:		
	Interlocal Agreement: <input type="checkbox"/> Yes <input checked="" type="checkbox"/> No If Yes, Name of Other Entity:						
REVISIONS	Location						
	Description: 3rd Street from Avenue A to Avenue B. Install new PCC pavement, curb, and gutter.						
STDS	If Revision, describe the changes:						
	Notification of Revision of One-Year Plan? <input type="checkbox"/> Yes <input type="checkbox"/> No If Yes, what is the reason? <input type="checkbox"/> Revisions to the Work/Project <input type="checkbox"/> Emergency Work/Proj Needed <input type="checkbox"/> Additional Funding Available <input type="checkbox"/> Other: _____						
TRAFF SPD	Functional Class National: Local		State: Local				
	Design Standards Table 2-001. 03. F		National Highway System: <input type="checkbox"/> Yes <input checked="" type="checkbox"/> No				
ROADWAY	Design Speed: 25 MPH		Posted/Anticipated Speed = 25 MPH				
	Avg Daily Traffic :	Initial Year 2018	VPD 100	Hvy Trucks % 5	Design Year 2050	VPD 200	Hvy Trucks % 5
BRIDGES & STRUCTURES	HIGHWAY, ROAD OR STREET		EXISTING		PROPOSED IMPROVEMENT		
	Traveled Way:	Surface Type Gravel	Width (ft) 35	Surface Type Concrete	Thickness (in) 6	Width (ft) 35	Work Type N&R
OTHER SCOPE	Shoulders:	Earth	4	Concrete	6	Curbed	
	BRIDGES AND STRUCTURES		EXISTING		PROPOSED IMPROVEMENT		
ANALYSES	Structure Number(s) City/County - NBIS		Structure Type	Condition SR SD FO	Structure Type	Size	Design Loading and Work Type
				____ <input type="checkbox"/> <input type="checkbox"/>			
FINANCIAL	Other Scope of Work:		<input checked="" type="checkbox"/> Grading	<input type="checkbox"/> Acquire Right of Way	<input type="checkbox"/> Remove Existing Bridge/Structure		
	<input type="checkbox"/> Add Auxiliary Lane(s)	<input type="checkbox"/> Guardrail	<input type="checkbox"/> Fencing	<input type="checkbox"/> Lighting	<input type="checkbox"/> Bridge Re-deck		
FINANCIAL	<input type="checkbox"/> Sidewalk/Trail	<input type="checkbox"/> Removal of Roadside Obstacles	<input checked="" type="checkbox"/> Curb Work	<input type="checkbox"/> Traffic Control Devices	<input type="checkbox"/> Bridge Rail		
	<input type="checkbox"/> Flatten Vertical Curve(s)	<input type="checkbox"/> Other: _____	<input checked="" type="checkbox"/> Curb Ramp(s)	<input type="checkbox"/> Construction Detour	<input type="checkbox"/> Storm Sewer or Culverts		
FINANCIAL	Drainage Study Completed for Structures/Drainage Facilities		Work/Project Relaxation of Standards Requested				
	<input type="checkbox"/> Yes <input type="checkbox"/> Pending <input checked="" type="checkbox"/> N/A		<input type="checkbox"/> Yes <input type="checkbox"/> Pending <input checked="" type="checkbox"/> N/A				
FINANCIAL	Analyses Completed:		Cost Effective Analysis		Other Benefit/Cost Analysis		
	<input type="checkbox"/> Yes <input type="checkbox"/> Pending <input checked="" type="checkbox"/> N/A		<input type="checkbox"/> Yes <input type="checkbox"/> Pending <input checked="" type="checkbox"/> N/A		<input type="checkbox"/> Yes <input type="checkbox"/> Pending <input checked="" type="checkbox"/> N/A		
FINANCIAL	Nebraska licensed engineer providing design and construction phases services: <input checked="" type="checkbox"/> Yes <input type="checkbox"/> No						
	Construction Period (estimated): 60.0 working days						
FINANCIAL	Other Funds to be Applied:		<input type="checkbox"/> Federal Fund Purchase Program	<input type="checkbox"/> State-Aid Bridge Fund	<input type="checkbox"/> Federal Funds thru NDOR		
	<input type="checkbox"/> LB960 County Bridge Match Program		<input type="checkbox"/> State Recreation Road Fund	<input type="checkbox"/> Other: _____			
FINANCIAL	Estimated Costs (1,000)	County	Municipality	State	Federal	Other	Total
			350				350
FINANCIAL	Print Name: Jeff Wolfe		Title: City Street Superintendent		Date: 11/11/2025		
	Signature: <i>Jeff Wolfe</i>						

One- And Six-Year Plan Highway, Road or Street Improvement Work/Project

GENERAL INFO	Name (County or Municipality): Bayard <input checked="" type="checkbox"/> Existing W/P <input type="checkbox"/> New W/P <input type="checkbox"/> Revision W/P							
	Work/Project (W/P) Number: M-137 (36c)		Work/Project Length: 300.00		feet			
	Other Work/Project Number:				Control Number:			
	Interlocal Agreement: <input type="checkbox"/> Yes <input type="checkbox"/> No If Yes, Name of Other Entity:							
GENERAL INFO	Location 1st Avenue from 5th Street to 6th Street. Install 1.5" bituminous overlay on existing PCC							
	Description: pavement							
REVISIONS	If Revision, describe the changes:							
	Notification of Revision of One-Year Plan? <input type="checkbox"/> Yes <input type="checkbox"/> No		If Yes, what is the reason?		<input type="checkbox"/> Revisions to the Work/Project <input type="checkbox"/> Emergency Work/Proj Needed <input type="checkbox"/> Additional Funding Available <input type="checkbox"/> Other: _____			
STDS	Functional Class National: Local		State: Local					
	Design Standards Table 2-001. 03. F		National Highway System: <input type="checkbox"/> Yes <input checked="" type="checkbox"/> No					
TRAFFIC SPD	Design Speed: 25 MPH Posted/Anticipated Speed = 25 MPH							
	Avg Daily Traffic :		Initial Year	VPD	Hvy Trucks %	Design Year	VPD	Hvy Trucks %
ROADWAY	HIGHWAY, ROAD OR STREET		EXISTING		PROPOSED IMPROVEMENT			
			Surface Type	Width (ft)	Surface Type	Thickness (in)	Width (ft)	Work Type
	Traveled Way:		Concrete	38	Composite Pavement	1.5	38	MAINT
	Shoulders:		Concrete	Curbed	Concrete	6	Curbed	
BRIDGES & STRUCTURES	BRIDGES AND STRUCTURES		EXISTING		PROPOSED IMPROVEMENT			
	Structure Number(s)		Structure	Condition		Structure Type	Size	Design Loading and Work Type
	City/County - NBIS		Type	SR	SD			
				_____	<input type="checkbox"/>	<input type="checkbox"/>		
				_____	<input type="checkbox"/>	<input type="checkbox"/>		
			_____	<input type="checkbox"/>	<input type="checkbox"/>			
OTHER SCOPE	Other Scope of Work:							
	<input type="checkbox"/> Add Auxiliary Lane(s) <input type="checkbox"/> Sidewalk/Trail <input type="checkbox"/> Removal of Roadside Obstacles <input type="checkbox"/> Flatten Vertical Curve(s) <input type="checkbox"/> Other: _____		<input type="checkbox"/> Grading <input type="checkbox"/> Guardrail <input type="checkbox"/> Fencing <input type="checkbox"/> Curb Work <input type="checkbox"/> Curb Ramp(s)		<input type="checkbox"/> Acquire Right of Way <input type="checkbox"/> Other Utilities Work <input type="checkbox"/> Lighting <input type="checkbox"/> Traffic Control Devices <input type="checkbox"/> Construction Detour		<input type="checkbox"/> Remove Existing Bridge/Structure <input type="checkbox"/> Bridge Re-deck <input type="checkbox"/> Bridge Rail <input type="checkbox"/> Storm Sewer or Culverts <input type="checkbox"/> Erosion Control	
ANALYSES	Drainage Study Completed for Structures/Drainage Facilities <input type="checkbox"/> Yes <input type="checkbox"/> Pending <input checked="" type="checkbox"/> N/A				Work/Project Relaxation of Standards Requested <input type="checkbox"/> Yes <input type="checkbox"/> Pending <input checked="" type="checkbox"/> N/A			
	Analyses Completed: <input type="checkbox"/> Yes <input type="checkbox"/> Pending <input checked="" type="checkbox"/> N/A				Other Benefit/Cost Analysis <input type="checkbox"/> Yes <input type="checkbox"/> Pending <input checked="" type="checkbox"/> N/A			
FINANCIAL	Nebraska licensed engineer providing design and construction phases services: <input checked="" type="checkbox"/> Yes <input type="checkbox"/> No							
	Construction Period (estimated): 30.0 working days							
	Other Funds to be Applied: <input type="checkbox"/> Federal Fund Purchase Program <input type="checkbox"/> State-Aid Bridge Fund <input type="checkbox"/> Federal Funds thru NDOR <input type="checkbox"/> LB960 County Bridge Match Program <input type="checkbox"/> State Recreation Road Fund <input type="checkbox"/> Other: _____							
Estimated Costs (1,000)		County	Municipality	State	Federal	Other	Total	
			100				100	
Print Name: Jeff Wolfe			Title: City Street Superintendent		Date: 11/11/2025			
Signature: <i>Jeff Wolfe</i>								

One- And Six-Year Plan Highway, Road or Street Improvement Work/Project

GENERAL INFO	Name (County or Municipality): Bayard <input checked="" type="checkbox"/> Existing W/P <input type="checkbox"/> New W/P <input type="checkbox"/> Revision W/P																																					
	Work/Project (W/P) Number: M-137 (48)	Work/Project Length: 0.30 miles																																				
	Other Work/Project Number:	Control Number:																																				
	Interlocal Agreement: <input type="checkbox"/> Yes <input type="checkbox"/> No If Yes, Name of Other Entity:																																					
REVISIONS	Location 13th Street from Main Street to Avenue C. Install new PCC pavement, curb, gutter, and																																					
	Description: walks.																																					
STDS	If Revision, describe the changes:																																					
	Notification of Revision of One-Year Plan? <input type="checkbox"/> Yes <input type="checkbox"/> No If Yes, what is the reason?																																					
TRAFF SPD	<input type="checkbox"/> Revisions to the Work/Project <input type="checkbox"/> Other: _____ <input type="checkbox"/> Emergency Work/Proj Needed _____ <input type="checkbox"/> Additional Funding Available _____																																					
	Functional Class National: Local State: Local Design Standards Table 2-001. 03. F National Highway System: <input type="checkbox"/> Yes <input checked="" type="checkbox"/> No																																					
ROADWAY	Design Speed: 25 MPH Posted/Anticipated Speed = 25 MPH																																					
	Avg Daily Traffic : <table border="1" style="display: inline-table; border-collapse: collapse; text-align: center;"> <tr> <td>Initial Year</td> <td>VPD</td> <td>Hvy Trucks %</td> <td>Design Year</td> <td>VPD</td> <td>Hvy Trucks %</td> </tr> <tr> <td>2018</td> <td>100</td> <td>5</td> <td>2050</td> <td>200</td> <td>5</td> </tr> </table>		Initial Year	VPD	Hvy Trucks %	Design Year	VPD	Hvy Trucks %	2018	100	5	2050	200	5																								
Initial Year	VPD	Hvy Trucks %	Design Year	VPD	Hvy Trucks %																																	
2018	100	5	2050	200	5																																	
BRIDGES & STRUCTURES	<table border="1" style="width: 100%; border-collapse: collapse;"> <tr> <th rowspan="2">HIGHWAY, ROAD OR STREET</th> <th colspan="2">EXISTING</th> <th colspan="3">PROPOSED IMPROVEMENT</th> </tr> <tr> <th>Surface Type</th> <th>Width (ft)</th> <th>Surface Type</th> <th>Thickness (in)</th> <th>Width (ft)</th> <th>Work Type</th> </tr> <tr> <td>Traveled Way:</td> <td>Gravel</td> <td>32</td> <td>Concrete</td> <td>6</td> <td>32</td> <td>N&R</td> </tr> <tr> <td>Shoulders:</td> <td>Earth</td> <td>4</td> <td>Concrete</td> <td>6</td> <td>Curbed</td> <td></td> </tr> </table>		HIGHWAY, ROAD OR STREET	EXISTING		PROPOSED IMPROVEMENT			Surface Type	Width (ft)	Surface Type	Thickness (in)	Width (ft)	Work Type	Traveled Way:	Gravel	32	Concrete	6	32	N&R	Shoulders:	Earth	4	Concrete	6	Curbed											
	HIGHWAY, ROAD OR STREET	EXISTING		PROPOSED IMPROVEMENT																																		
Surface Type		Width (ft)	Surface Type	Thickness (in)	Width (ft)	Work Type																																
Traveled Way:	Gravel	32	Concrete	6	32	N&R																																
Shoulders:	Earth	4	Concrete	6	Curbed																																	
OTHER SCOPE	<table border="1" style="width: 100%; border-collapse: collapse;"> <tr> <th colspan="2">BRIDGES AND STRUCTURES</th> <th colspan="2">EXISTING</th> <th colspan="2">PROPOSED IMPROVEMENT</th> </tr> <tr> <th>Structure Number(s)</th> <th>Structure Type</th> <th colspan="2">Condition</th> <th>Structure Type</th> <th>Design Loading and Work Type</th> </tr> <tr> <td>City/County - NBIS</td> <td></td> <th>SR</th> <th>SD</th> <th>FO</th> <td></td> </tr> <tr> <td></td> <td></td> <td>_____ <input type="checkbox"/></td> <td>_____ <input type="checkbox"/></td> <td>_____ <input type="checkbox"/></td> <td></td> </tr> <tr> <td></td> <td></td> <td>_____ <input type="checkbox"/></td> <td>_____ <input type="checkbox"/></td> <td>_____ <input type="checkbox"/></td> <td></td> </tr> <tr> <td></td> <td></td> <td>_____ <input type="checkbox"/></td> <td>_____ <input type="checkbox"/></td> <td>_____ <input type="checkbox"/></td> <td></td> </tr> </table>		BRIDGES AND STRUCTURES		EXISTING		PROPOSED IMPROVEMENT		Structure Number(s)	Structure Type	Condition		Structure Type	Design Loading and Work Type	City/County - NBIS		SR	SD	FO				_____ <input type="checkbox"/>	_____ <input type="checkbox"/>	_____ <input type="checkbox"/>				_____ <input type="checkbox"/>	_____ <input type="checkbox"/>	_____ <input type="checkbox"/>				_____ <input type="checkbox"/>	_____ <input type="checkbox"/>	_____ <input type="checkbox"/>	
	BRIDGES AND STRUCTURES		EXISTING		PROPOSED IMPROVEMENT																																	
Structure Number(s)	Structure Type	Condition		Structure Type	Design Loading and Work Type																																	
City/County - NBIS		SR	SD	FO																																		
		_____ <input type="checkbox"/>	_____ <input type="checkbox"/>	_____ <input type="checkbox"/>																																		
		_____ <input type="checkbox"/>	_____ <input type="checkbox"/>	_____ <input type="checkbox"/>																																		
		_____ <input type="checkbox"/>	_____ <input type="checkbox"/>	_____ <input type="checkbox"/>																																		
ANALYSES	Other Scope of Work: <input checked="" type="checkbox"/> Grading <input type="checkbox"/> Acquire Right of Way <input type="checkbox"/> Remove Existing Bridge/Structure <input type="checkbox"/> Add Auxiliary Lane(s) <input type="checkbox"/> Guardrail <input type="checkbox"/> Other Utilities Work <input type="checkbox"/> Bridge Re-deck <input type="checkbox"/> Sidewalk/Trail <input type="checkbox"/> Fencing <input type="checkbox"/> Lighting <input type="checkbox"/> Bridge Rail <input type="checkbox"/> Removal of Roadside Obstacles <input checked="" type="checkbox"/> Curb Work <input type="checkbox"/> Traffic Control Devices <input type="checkbox"/> Storm Sewer or Culverts <input type="checkbox"/> Flatten Vertical Curve(s) <input checked="" type="checkbox"/> Curb Ramp(s) <input type="checkbox"/> Construction Detour <input type="checkbox"/> Erosion Control <input type="checkbox"/> Other: _____																																					
	Drainage Study Completed for Structures/Drainage Facilities <input type="checkbox"/> Yes <input type="checkbox"/> Pending <input checked="" type="checkbox"/> N/A Work/Project Relaxation of Standards Requested <input type="checkbox"/> Yes <input type="checkbox"/> Pending <input checked="" type="checkbox"/> N/A Analyses Completed: <input type="checkbox"/> Yes <input type="checkbox"/> Pending <input checked="" type="checkbox"/> N/A Other Benefit/Cost Analysis <input type="checkbox"/> Yes <input type="checkbox"/> Pending <input checked="" type="checkbox"/> N/A																																					
FINANCIAL	Nebraska licensed engineer providing design and construction phases services: <input checked="" type="checkbox"/> Yes <input type="checkbox"/> No Construction Period (estimated): 90.0 working days																																					
	Other Funds to be Applied: <input type="checkbox"/> Federal Fund Purchase Program <input type="checkbox"/> State-Aid Bridge Fund <input type="checkbox"/> Federal Funds thru NDOR <input type="checkbox"/> LB960 County Bridge Match Program <input type="checkbox"/> State Recreation Road Fund <input type="checkbox"/> Other: _____																																					
FINANCIAL	<table border="1" style="width: 100%; border-collapse: collapse;"> <tr> <th>Estimated Costs (1,000)</th> <th>County</th> <th>Municipality</th> <th>State</th> <th>Federal</th> <th>Other</th> <th>Total</th> </tr> <tr> <td></td> <td></td> <td>350</td> <td></td> <td></td> <td></td> <td>350</td> </tr> </table>		Estimated Costs (1,000)	County	Municipality	State	Federal	Other	Total			350				350																						
	Estimated Costs (1,000)	County	Municipality	State	Federal	Other	Total																															
		350				350																																
FINANCIAL	Print Name: Jeff Wolfe Title: City Street Superintendent																																					
	Signature: <i>Jeff Wolfe</i> Date: 11/11/2025																																					

One- And Six-Year Plan Highway, Road or Street Improvement Work/Project

GENERAL INFO	Name (County or Municipality): Bayard <input checked="" type="checkbox"/> Existing W/P <input type="checkbox"/> New W/P <input type="checkbox"/> Revision W/P							
	Work/Project (W/P) Number: M-137 (49)		Work/Project Length: 0.30		miles			
	Other Work/Project Number:				Control Number:			
	Interlocal Agreement: <input type="checkbox"/> Yes <input type="checkbox"/> No If Yes, Name of Other Entity:							
REVISIONS	Location 14th Street from Main Street to Avenue C. Install new PCC pavement, curb, gutter, and							
	Description: walks.							
STDS	If Revision, describe the changes:							
	Notification of Revision of One-Year Plan? <input type="checkbox"/> Yes <input type="checkbox"/> No If Yes, what is the reason? <input type="checkbox"/> Revisions to the Work/Project <input type="checkbox"/> Emergency Work/Proj Needed <input type="checkbox"/> Additional Funding Available <input type="checkbox"/> Other: _____							
TRAFFIC	Functional Class National: Local		State: Local					
	Design Standards Table 2-001. 03. F		National Highway System: <input type="checkbox"/> Yes <input checked="" type="checkbox"/> No					
ROADWAY	Design Speed: 25 MPH		Posted/Anticipated Speed = 25 MPH					
	Avg Daily Traffic :		Initial Year 2018	VPD 100	Hvy Trucks % 5	Design Year 2050	VPD 200	Hvy Trucks % 5
BRIDGES & STRUCTURES	HIGHWAY, ROAD OR STREET		EXISTING		PROPOSED IMPROVEMENT			
			Surface Type	Width (ft)	Surface Type	Thickness (in)	Width (ft)	Work Type
	Traveled Way:		Gravel	32	Concrete	6	32	N&R
OTHER SCOPE	Shoulders:		Earth	4	Concrete	6	Curbed	
	BRIDGES AND STRUCTURES		EXISTING		PROPOSED IMPROVEMENT			
	Structure Number(s)		Structure Type	Condition		Structure Type	Size	Design Loading and Work Type
	City/County - NBIS			SR	SD			
			_____	<input type="checkbox"/>	<input type="checkbox"/>			
			_____	<input type="checkbox"/>	<input type="checkbox"/>			
			_____	<input type="checkbox"/>	<input type="checkbox"/>			
			_____	<input type="checkbox"/>	<input type="checkbox"/>			
ANALYSES	Other Scope of Work:		<input checked="" type="checkbox"/> Grading	<input type="checkbox"/> Acquire Right of Way	<input type="checkbox"/> Remove Existing Bridge/Structure			
	<input type="checkbox"/> Add Auxiliary Lane(s)		<input type="checkbox"/> Guardrail	<input type="checkbox"/> Other Utilities Work	<input type="checkbox"/> Bridge Re-deck			
<input type="checkbox"/> Sidewalk/Trail		<input type="checkbox"/> Fencing	<input type="checkbox"/> Lighting	<input type="checkbox"/> Bridge Rail				
<input type="checkbox"/> Removal of Roadside Obstacles		<input checked="" type="checkbox"/> Curb Work	<input type="checkbox"/> Traffic Control Devices	<input type="checkbox"/> Storm Sewer or Culverts				
<input type="checkbox"/> Flatten Vertical Curve(s)		<input checked="" type="checkbox"/> Curb Ramp(s)	<input type="checkbox"/> Construction Detour	<input type="checkbox"/> Erosion Control				
<input type="checkbox"/> Other: _____								
FINANCIAL	Drainage Study Completed for Structures/Drainage Facilities <input type="checkbox"/> Yes <input type="checkbox"/> Pending <input checked="" type="checkbox"/> N/A				Work/Project Relaxation of Standards Requested <input type="checkbox"/> Yes <input type="checkbox"/> Pending <input checked="" type="checkbox"/> N/A			
	Analyses Completed: <input type="checkbox"/> Yes <input type="checkbox"/> Pending <input checked="" type="checkbox"/> N/A				Other Benefit/Cost Analysis <input type="checkbox"/> Yes <input type="checkbox"/> Pending <input checked="" type="checkbox"/> N/A			
Nebraska licensed engineer providing design and construction phases services: <input checked="" type="checkbox"/> Yes <input type="checkbox"/> No								
Construction Period (estimated):				90.0 working days				
Other Funds to be Applied:		<input type="checkbox"/> Federal Fund Purchase Program	<input type="checkbox"/> State-Aid Bridge Fund	<input type="checkbox"/> Federal Funds thru NDOR				
		<input type="checkbox"/> LB960 County Bridge Match Program	<input type="checkbox"/> State Recreation Road Fund	<input type="checkbox"/> Other: _____				
Estimated Costs (1,000)		County	Municipality	State	Federal	Other	Total	
			350				350	
Print Name: Jeff Wolfe		Signature: <i>Jeff Wolfe</i>		Title: City Street Superintendent	Date: 11/11/2025			

One- And Six-Year Plan Highway, Road or Street Improvement Work/Project

GENERAL INFO	Name (County or Municipality): Bayard <input checked="" type="checkbox"/> Existing W/P <input type="checkbox"/> New W/P <input type="checkbox"/> Revision W/P																		
	Work/Project (W/P) Number: M-137 (50)		Work/Project Length: N/A		miles														
	Other Work/Project Number:				Control Number:														
	Interlocal Agreement: <input type="checkbox"/> Yes <input type="checkbox"/> No If Yes, Name of Other Entity:																		
REVISIONS	Location																		
	Description: City wide ADA access ramps																		
STDS	If Revision, describe the changes:																		
	Notification of Revision of One-Year Plan? <input type="checkbox"/> Yes <input type="checkbox"/> No If Yes, what is the reason?																		
TRAFF SPD	<input type="checkbox"/> Revisions to the Work/Project <input type="checkbox"/> Other: _____ <input type="checkbox"/> Emergency Work/Proj Needed _____ <input type="checkbox"/> Additional Funding Available _____																		
	Functional Class National: Local State: Local Design Standards Table 2-001. 03. F National Highway System: <input type="checkbox"/> Yes <input checked="" type="checkbox"/> No																		
ROADWAY	Design Speed: 25 MPH Posted/Anticipated Speed = 25 MPH																		
	<table border="1" style="width: 100%; border-collapse: collapse;"> <tr> <td rowspan="2">Avg Daily Traffic :</td> <td>Initial Year</td> <td>VPD</td> <td>Hvy Trucks %</td> <td>Design Year</td> <td>VPD</td> <td>Hvy Trucks %</td> </tr> <tr> <td>2025</td> <td>100</td> <td>5</td> <td>2055</td> <td>200</td> <td>5</td> </tr> </table>							Avg Daily Traffic :	Initial Year	VPD	Hvy Trucks %	Design Year	VPD	Hvy Trucks %	2025	100	5	2055	200
Avg Daily Traffic :	Initial Year	VPD	Hvy Trucks %	Design Year	VPD	Hvy Trucks %													
	2025	100	5	2055	200	5													
BRIDGES & STRUCTURES	HIGHWAY, ROAD OR STREET		EXISTING		PROPOSED IMPROVEMENT														
			Surface Type	Width (ft)	Surface Type	Thickness (in)	Width (ft)	Work Type											
Traveled Way:		Concrete	Varies	Concrete	6	Varies	3R												
Shoulders:		Concrete	Varies	Concrete	6	Curbed													
OTHER SCOPE	BRIDGES AND STRUCTURES		EXISTING		PROPOSED IMPROVEMENT														
	Structure Number(s) City/County - NBIS		Structure Type	Condition SR SD FO	Structure Type	Size	Design Loading and Work Type												
			____ <input type="checkbox"/> <input type="checkbox"/>																
			____ <input type="checkbox"/> <input type="checkbox"/>																
			____ <input type="checkbox"/> <input type="checkbox"/>																
			____ <input type="checkbox"/> <input type="checkbox"/>																
ANALYSES	Other Scope of Work:																		
	<input type="checkbox"/> Add Auxiliary Lane(s) <input type="checkbox"/> Grading <input type="checkbox"/> Acquire Right of Way <input type="checkbox"/> Remove Existing Bridge/Structure <input type="checkbox"/> Sidewalk/Trail <input type="checkbox"/> Guardrail <input type="checkbox"/> Other Utilities Work <input type="checkbox"/> Bridge Re-deck <input type="checkbox"/> Removal of Roadside Obstacles <input type="checkbox"/> Fencing <input type="checkbox"/> Lighting <input type="checkbox"/> Bridge Rail <input type="checkbox"/> Flatten Vertical Curve(s) <input checked="" type="checkbox"/> Curb Work <input type="checkbox"/> Traffic Control Devices <input type="checkbox"/> Storm Sewer or Culverts <input type="checkbox"/> Other: _____ <input checked="" type="checkbox"/> Curb Ramp(s) <input type="checkbox"/> Construction Detour <input type="checkbox"/> Erosion Control																		
FINANCIAL	Drainage Study Completed for Structures/Drainage Facilities <input type="checkbox"/> Yes <input type="checkbox"/> Pending <input checked="" type="checkbox"/> N/A																		
	Work/Project Relaxation of Standards Requested <input type="checkbox"/> Yes <input type="checkbox"/> Pending <input checked="" type="checkbox"/> N/A																		
Analyses Completed: <input type="checkbox"/> Yes <input type="checkbox"/> Pending <input checked="" type="checkbox"/> N/A																			
Cost Effective Analysis <input type="checkbox"/> Yes <input type="checkbox"/> Pending <input checked="" type="checkbox"/> N/A																			
Other Benefit/Cost Analysis <input type="checkbox"/> Yes <input type="checkbox"/> Pending <input checked="" type="checkbox"/> N/A																			
Nebraska licensed engineer providing design and construction phases services: <input checked="" type="checkbox"/> Yes <input type="checkbox"/> No																			
Construction Period (estimated): 60.0 working days																			
Other Funds to be Applied:																			
<input type="checkbox"/> Federal Fund Purchase Program <input type="checkbox"/> State-Aid Bridge Fund <input type="checkbox"/> Federal Funds thru NDOR <input type="checkbox"/> LB960 County Bridge Match Program <input type="checkbox"/> State Recreation Road Fund <input type="checkbox"/> Other: _____																			
<table border="1" style="width: 100%; border-collapse: collapse;"> <tr> <td rowspan="2">Estimated Costs (1,000)</td> <td>County</td> <td>Municipality</td> <td>State</td> <td>Federal</td> <td>Other</td> <td>Total</td> </tr> <tr> <td></td> <td>75</td> <td></td> <td></td> <td></td> <td>75</td> </tr> </table>							Estimated Costs (1,000)	County	Municipality	State	Federal	Other	Total		75				75
Estimated Costs (1,000)	County	Municipality	State	Federal	Other	Total													
		75				75													
Print Name: Jeff Wolfe																			
Signature: <i>Jeff Wolfe</i>		Title: City Street Superintendent		Date: 11/11/2025															

One- And Six-Year Plan Highway, Road or Street Improvement Work/Project

GENERAL INFO	Name (County or Municipality): Bayard <input checked="" type="checkbox"/> Existing W/P <input type="checkbox"/> New W/P <input type="checkbox"/> Revision W/P						
	Work/Project (W/P) Number: M-137 (51)		Work/Project Length: 0.20 miles				
	Other Work/Project Number:				Control Number:		
	Interlocal Agreement: <input type="checkbox"/> Yes <input type="checkbox"/> No If Yes, Name of Other Entity:						
GENERAL INFO	Location						
	Description: Avenue A from 10th Street to 11th Street. Seal coat existing asphalt surface						
REVISIONS	If Revision, describe the changes:						
	Notification of Revision of One-Year Plan? <input type="checkbox"/> Yes <input type="checkbox"/> No		If Yes, what is the reason?		<input type="checkbox"/> Revisions to the Work/Project <input type="checkbox"/> Emergency Work/Proj Needed <input type="checkbox"/> Additional Funding Available <input type="checkbox"/> Other: _____		
STDS	Functional Class National: Local		State: Local				
	Design Standards Table 2-001. 03. F		National Highway System: <input type="checkbox"/> Yes <input checked="" type="checkbox"/> No				
TRAFFIC SPD	Design Speed: 25 MPH Posted/Anticipated Speed = 25 MPH						
	Avg Daily Traffic :	Initial Year 2025	VPD 100	Hvy Trucks % 5	Design Year 2055	VPD 200	Hvy Trucks % 5
ROADWAY	HIGHWAY, ROAD OR STREET		EXISTING		PROPOSED IMPROVEMENT		
		Surface Type	Width (ft)	Surface Type	Thickness (in)	Width (ft)	Work Type
	Traveled Way:	Asphalt	32	Asphalt	0.5	32	MAINT
	Shoulders:	Concrete	Curbed	Concrete	6	Curbed	
BRIDGES & STRUCTURES	BRIDGES AND STRUCTURES		EXISTING		PROPOSED IMPROVEMENT		
	Structure Number(s) City/County - NBIS		Structure Type	Condition SR SD FO	Structure Type	Size	Design Loading and Work Type
				____ <input type="checkbox"/> <input type="checkbox"/>			
				____ <input type="checkbox"/> <input type="checkbox"/>			
				____ <input type="checkbox"/> <input type="checkbox"/>			
OTHER SCOPE	Other Scope of Work:						
	<input type="checkbox"/> Add Auxiliary Lane(s) <input type="checkbox"/> Sidewalk/Trail <input type="checkbox"/> Removal of Roadside Obstacles <input type="checkbox"/> Flatten Vertical Curve(s) <input type="checkbox"/> Other: _____	<input type="checkbox"/> Grading <input type="checkbox"/> Guardrail <input type="checkbox"/> Fencing <input type="checkbox"/> Curb Work <input type="checkbox"/> Curb Ramp(s)	<input type="checkbox"/> Acquire Right of Way <input type="checkbox"/> Other Utilities Work <input type="checkbox"/> Lighting <input type="checkbox"/> Traffic Control Devices <input type="checkbox"/> Construction Detour	<input type="checkbox"/> Remove Existing Bridge/Structure <input type="checkbox"/> Bridge Re-deck <input type="checkbox"/> Bridge Rail <input type="checkbox"/> Storm Sewer or Culverts <input type="checkbox"/> Erosion Control			
ANALYSES	Drainage Study Completed for Structures/Drainage Facilities <input type="checkbox"/> Yes <input type="checkbox"/> Pending <input checked="" type="checkbox"/> N/A				Work/Project Relaxation of Standards Requested <input type="checkbox"/> Yes <input type="checkbox"/> Pending <input checked="" type="checkbox"/> N/A		
	Analyses Completed: <input type="checkbox"/> Yes <input type="checkbox"/> Pending <input checked="" type="checkbox"/> N/A				Other Benefit/Cost Analysis <input type="checkbox"/> Yes <input type="checkbox"/> Pending <input checked="" type="checkbox"/> N/A		
FINANCIAL	Nebraska licensed engineer providing design and construction phases services: <input checked="" type="checkbox"/> Yes <input type="checkbox"/> No						
	Construction Period (estimated): 10.0 working days						
	Other Funds to be Applied: <input type="checkbox"/> Federal Fund Purchase Program <input type="checkbox"/> State-Aid Bridge Fund <input type="checkbox"/> Federal Funds thru NDOR <input type="checkbox"/> LB960 County Bridge Match Program <input type="checkbox"/> State Recreation Road Fund <input type="checkbox"/> Other: _____						
Estimated Costs (1,000)		County	Municipality	State	Federal	Other	Total
			30				30
Print Name: Jeff Wolfe			Title: City Street Superintendent		Date: 11/11/2025		
Signature: <i>Jeff Wolfe</i>							

One- And Six-Year Plan Highway, Road or Street Improvement Work/Project

GENERAL INFO	Name (County or Municipality): Bayard <input type="checkbox"/> Existing W/P <input checked="" type="checkbox"/> New W/P <input type="checkbox"/> Revision W/P						
	Work/Project (W/P) Number: M-137 (53)		Work/Project Length: 0.10		miles		
	Other Work/Project Number:				Control Number:		
	Interlocal Agreement: <input type="checkbox"/> Yes <input type="checkbox"/> No If Yes, Name of Other Entity:						
REVISIONS	Location						
	Description: Reconsturct 8th Street, new curb, gutter and pavement - Main Street to 1st Avenue						
STDS	If Revision, describe the changes:						
	Notification of Revision of One-Year Plan? <input type="checkbox"/> Yes <input type="checkbox"/> No If Yes, what is the reason? <input type="checkbox"/> Revisions to the Work/Project <input type="checkbox"/> Emergency Work/Proj Needed <input type="checkbox"/> Additional Funding Available <input type="checkbox"/> Other: _____						
SPD	Functional Class <i>National:</i> Major Collector		State: Other Arterial				
	Design Standards Table 2-001. 03. F		National Highway System: <input type="checkbox"/> Yes <input checked="" type="checkbox"/> No				
TRAFFIC	Design Speed: 25 MPH		Posted/Anticipated Speed = 25 MPH				
	Avg Daily Traffic :	Initial Year 2025	VPD 200	Hvy Trucks % 10	Design Year 2055	VPD 300	Hvy Trucks % 12
ROADWAY	HIGHWAY, ROAD OR STREET		EXISTING		PROPOSED IMPROVEMENT		
		Surface Type	Width (ft)	Surface Type	Thickness (in)	Width (ft)	Work Type
	Traveled Way:	Concrete	39	Concrete	6	39	3R
BRIDGES & STRUCTURES	Shoulders:		Concrete	Curbed	Concrete	6	Curbed
	BRIDGES AND STRUCTURES		EXISTING		PROPOSED IMPROVEMENT		
	Structure Number(s) City/County - NBIS		Structure Type	Condition SR SD FO		Structure Type	Size
OTHER SCOPE	Other Scope of Work:		<input type="checkbox"/> Grading <input type="checkbox"/> Acquire Right of Way <input type="checkbox"/> Remove Existing Bridge/Structure				
	<input type="checkbox"/> Add Auxiliary Lane(s)		<input type="checkbox"/> Guardrail <input type="checkbox"/> Other Utilities Work <input type="checkbox"/> Bridge Re-deck				
	<input type="checkbox"/> Sidewalk/Trail		<input type="checkbox"/> Fencing <input type="checkbox"/> Lighting <input type="checkbox"/> Bridge Rail				
	<input type="checkbox"/> Removal of Roadside Obstacles		<input checked="" type="checkbox"/> Curb Work <input type="checkbox"/> Traffic Control Devices <input type="checkbox"/> Storm Sewer or Culverts				
ANALYSES	<input type="checkbox"/> Flatten Vertical Curve(s)		<input type="checkbox"/> Curb Ramp(s) <input type="checkbox"/> Construction Detour <input type="checkbox"/> Erosion Control				
	<input type="checkbox"/> Other: _____						
	Drainage Study Completed for Structures/Drainage Facilities <input type="checkbox"/> Yes <input type="checkbox"/> Pending <input checked="" type="checkbox"/> N/A				Work/Project Relaxation of Standards Requested <input type="checkbox"/> Yes <input type="checkbox"/> Pending <input checked="" type="checkbox"/> N/A		
FINANCIAL	Analyses Completed: <input type="checkbox"/> Yes <input type="checkbox"/> Pending <input checked="" type="checkbox"/> N/A				Other Benefit/Cost Analysis <input type="checkbox"/> Yes <input type="checkbox"/> Pending <input checked="" type="checkbox"/> N/A		
	Nebraska licensed engineer providing design and construction phases services: <input checked="" type="checkbox"/> Yes <input type="checkbox"/> No						
Construction Period (estimated): 40.0 working days							
FINANCIAL	Other Funds to be Applied:		<input type="checkbox"/> Federal Fund Purchase Program <input type="checkbox"/> State-Aid Bridge Fund <input type="checkbox"/> Federal Funds thru NDOR				
	<input type="checkbox"/> LB960 County Bridge Match Program <input type="checkbox"/> State Recreation Road Fund <input type="checkbox"/> Other: _____						
FINANCIAL	Estimated Costs (1,000)	County	Municipality	State	Federal	Other	Total
			350				350
FINANCIAL	Print Name: Jeff Wolfe		Title: City Street Superintendent		Date: 11/11/2025		
	Signature: <i>Jeff Wolfe</i>						

One- And Six-Year Plan Highway, Road or Street Improvement Work/Project

GENERAL INFO	Name (County or Municipality): Bayard <input type="checkbox"/> Existing W/P <input checked="" type="checkbox"/> New W/P <input type="checkbox"/> Revision W/P							
	Work/Project (W/P) Number: M-137 (54)		Work/Project Length: 0.10		miles			
	Other Work/Project Number:				Control Number:			
	Interlocal Agreement: <input type="checkbox"/> Yes <input type="checkbox"/> No If Yes, Name of Other Entity:							
REVISIONS	Location							
	Description: Reconsturct Intersection - 6th Street & 1st Avenue							
STNDS	If Revision, describe the changes:							
	Notification of Revision of One-Year Plan? <input type="checkbox"/> Yes <input type="checkbox"/> No If Yes, what is the reason? <input type="checkbox"/> Revisions to the Work/Project <input type="checkbox"/> Emergency Work/Proj Needed <input type="checkbox"/> Additional Funding Available <input type="checkbox"/> Other: _____							
TRAFF SPD	Functional Class National: Local		State: Local					
	Design Standards Table 2-001. 03. F		National Highway System: <input type="checkbox"/> Yes <input checked="" type="checkbox"/> No					
ROADWAY	Design Speed: 25 MPH		Posted/Anticipated Speed = 25 MPH					
	Avg Daily Traffic :		Initial Year 2025	VPD 100	Hvy Trucks % 5	Design Year 2055	VPD 200	Hvy Trucks % 5
BRIDGES & STRUCTURES	HIGHWAY, ROAD OR STREET		EXISTING		PROPOSED IMPROVEMENT			
			Surface Type	Width (ft)	Surface Type	Thickness (in)	Width (ft)	Work Type
	Traveled Way:		Concrete	30	Concrete	6	30	3R
Shoulders:		Concrete	Curbed	Concrete	6	Curbed		
OTHER SCOPE	BRIDGES AND STRUCTURES		EXISTING		PROPOSED IMPROVEMENT			
	Structure Number(s)		Structure	Condition			Design Loading	
	City/County - NBIS		Type	SR SD FO	Structure Type	Size	and Work Type	
				<input type="checkbox"/> <input type="checkbox"/> <input type="checkbox"/>				
				<input type="checkbox"/> <input type="checkbox"/> <input type="checkbox"/>				
ANALYSES	Other Scope of Work:		<input type="checkbox"/> Grading <input type="checkbox"/> Acquire Right of Way <input type="checkbox"/> Remove Existing Bridge/Structure					
	<input type="checkbox"/> Add Auxiliary Lane(s)		<input type="checkbox"/> Guardrail <input type="checkbox"/> Other Utilities Work <input type="checkbox"/> Bridge Re-deck					
FINANCIAL	<input type="checkbox"/> Sidewalk/Trail		<input type="checkbox"/> Fencing <input type="checkbox"/> Lighting <input type="checkbox"/> Bridge Rail					
	<input type="checkbox"/> Removal of Roadside Obstacles		<input checked="" type="checkbox"/> Curb Work <input type="checkbox"/> Traffic Control Devices <input type="checkbox"/> Storm Sewer or Culverts					
	<input type="checkbox"/> Flatten Vertical Curve(s)		<input type="checkbox"/> Curb Ramp(s) <input type="checkbox"/> Construction Detour <input type="checkbox"/> Erosion Control					
<input type="checkbox"/> Other: _____								
Drainage Study Completed for Structures/Drainage Facilities <input type="checkbox"/> Yes <input type="checkbox"/> Pending <input checked="" type="checkbox"/> N/A				Work/Project Relaxation of Standards Requested <input type="checkbox"/> Yes <input type="checkbox"/> Pending <input checked="" type="checkbox"/> N/A				
Analyses Completed: <input type="checkbox"/> Yes <input type="checkbox"/> Pending <input checked="" type="checkbox"/> N/A				Cost Effective Analysis <input type="checkbox"/> Yes <input type="checkbox"/> Pending <input checked="" type="checkbox"/> N/A				
				Other Benefit/Cost Analysis <input type="checkbox"/> Yes <input type="checkbox"/> Pending <input checked="" type="checkbox"/> N/A				
Nebraska licensed engineer providing design and construction phases services: <input checked="" type="checkbox"/> Yes <input type="checkbox"/> No								
Construction Period (estimated): 40.0 working days								
Other Funds to be Applied: <input type="checkbox"/> Federal Fund Purchase Program <input type="checkbox"/> State-Aid Bridge Fund <input type="checkbox"/> Federal Funds thru NDOR <input type="checkbox"/> LB960 County Bridge Match Program <input type="checkbox"/> State Recreation Road Fund <input type="checkbox"/> Other: _____								
Estimated Costs (1,000)		County	Municipality	State	Federal	Other	Total	
			300				300	
Print Name: Jeff Wolfe			Title: City Street Superintendent		Date: 11/11/2025			
Signature: <i>Jeff Wolfe</i>								

One- And Six-Year Plan Highway, Road or Street Improvement Work/Project

GENERAL INFO	Name (County or Municipality): Bayard <input type="checkbox"/> Existing W/P <input checked="" type="checkbox"/> New W/P <input type="checkbox"/> Revision W/P						
	Work/Project (W/P) Number: M-137 (55)		Work/Project Length: 0.10		miles		
	Other Work/Project Number:				Control Number:		
	Interlocal Agreement: <input type="checkbox"/> Yes <input type="checkbox"/> No If Yes, Name of Other Entity:						
GENERAL INFO	Location						
	Description: Reconsturct 5th Street, new curb, gutter, pavement - Avenue A to Avenue B						
REVISIONS	If Revision, describe the changes:						
	Notification of Revision of One-Year Plan? <input type="checkbox"/> Yes <input type="checkbox"/> No		If Yes, what is the reason?		<input type="checkbox"/> Revisions to the Work/Project <input type="checkbox"/> Emergency Work/Proj Needed <input type="checkbox"/> Additional Funding Available <input type="checkbox"/> Other: _____		
STDS	Functional Class National: Local		State: Local				
	Design Standards Table 2-001. 03. F		National Highway System: <input type="checkbox"/> Yes <input checked="" type="checkbox"/> No				
TRAFFIC	Design Speed: 25 MPH		Posted/Anticipated Speed = 25 MPH				
	Avg Daily Traffic :	Initial Year 2025	VPD 100	Hvy Trucks % 5	Design Year 2055	VPD 200	Hvy Trucks % 5
ROADWAY	HIGHWAY, ROAD OR STREET		EXISTING		PROPOSED IMPROVEMENT		
		Surface Type	Width (ft)	Surface Type	Thickness (in)	Width (ft)	Work Type
	Traveled Way:	Concrete	29	Concrete	6	29	3R
BRIDGES & STRUCTURES	Shoulders:		Concrete	Curbed	Concrete	6	Curbed
	BRIDGES AND STRUCTURES		EXISTING		PROPOSED IMPROVEMENT		
	Structure Number(s) City/County - NBIS		Structure Type	Condition SR SD FO	Structure Type	Size	Design Loading and Work Type
OTHER SCOPE	Other Scope of Work:		<input type="checkbox"/> Grading <input type="checkbox"/> Acquire Right of Way <input type="checkbox"/> Add Auxiliary Lane(s) <input type="checkbox"/> Guardrail <input type="checkbox"/> Other Utilities Work <input type="checkbox"/> Sidewalk/Trail <input type="checkbox"/> Fencing <input type="checkbox"/> Lighting <input type="checkbox"/> Removal of Roadside Obstacles <input checked="" type="checkbox"/> Curb Work <input type="checkbox"/> Traffic Control Devices <input type="checkbox"/> Flatten Vertical Curve(s) <input type="checkbox"/> Curb Ramp(s) <input type="checkbox"/> Construction Detour <input type="checkbox"/> Other: _____		<input type="checkbox"/> Remove Existing Bridge/Structure <input type="checkbox"/> Bridge Re-deck <input type="checkbox"/> Bridge Rail <input type="checkbox"/> Storm Sewer or Culverts <input type="checkbox"/> Erosion Control		
	Drainage Study Completed for Structures/Drainage Facilities		Work/Project Relaxation of Standards Requested				
	<input type="checkbox"/> Yes <input type="checkbox"/> Pending <input checked="" type="checkbox"/> N/A		<input type="checkbox"/> Yes <input type="checkbox"/> Pending <input checked="" type="checkbox"/> N/A				
ANALYSES	Analyses Completed:		Cost Effective Analysis		Other Benefit/Cost Analysis		
	<input type="checkbox"/> Yes <input type="checkbox"/> Pending <input checked="" type="checkbox"/> N/A		<input type="checkbox"/> Yes <input type="checkbox"/> Pending <input checked="" type="checkbox"/> N/A		<input type="checkbox"/> Yes <input type="checkbox"/> Pending <input checked="" type="checkbox"/> N/A		
FINANCIAL	Nebraska licensed engineer providing design and construction phases services: <input checked="" type="checkbox"/> Yes <input type="checkbox"/> No						
	Construction Period (estimated): 40.0 working days						
	Other Funds to be Applied:		<input type="checkbox"/> Federal Fund Purchase Program <input type="checkbox"/> LB960 County Bridge Match Program		<input type="checkbox"/> State-Aid Bridge Fund <input type="checkbox"/> State Recreation Road Fund		<input type="checkbox"/> Federal Funds thru NDOR <input type="checkbox"/> Other: _____
FINANCIAL	Estimated Costs (1,000)	County	Municipality	State	Federal	Other	Total
			350				350
FINANCIAL	Print Name: Jeff Wolfe		Title: City Street Superintendent		Date: 11/11/2025		
	Signature: <i>Jeff Wolfe</i>						

One- And Six-Year Plan Highway, Road or Street Improvement Work/Project

GENERAL INFO	Name (County or Municipality): Bayard <input type="checkbox"/> Existing W/P <input checked="" type="checkbox"/> New W/P <input type="checkbox"/> Revision W/P						
	Work/Project (W/P) Number: M-137 (56)		Work/Project Length: 0.10		miles		
	Other Work/Project Number:				Control Number:		
	Interlocal Agreement: <input type="checkbox"/> Yes <input type="checkbox"/> No If Yes, Name of Other Entity:						
REVISIONS	Location						
	Description: Reconstruct Avenue B, new curb, gutter, pavement - 5th Street to 6th Street						
STDS	If Revision, describe the changes:						
	Notification of Revision of One-Year Plan? <input type="checkbox"/> Yes <input type="checkbox"/> No If Yes, what is the reason? <input type="checkbox"/> Revisions to the Work/Project <input type="checkbox"/> Emergency Work/Proj Needed <input type="checkbox"/> Additional Funding Available <input type="checkbox"/> Other: _____						
TRAFFIC	Functional Class National: Local		State: Local				
	Design Standards Table 2-001. 03. F		National Highway System: <input type="checkbox"/> Yes <input checked="" type="checkbox"/> No				
ROADWAY	Design Speed: 25 MPH		Posted/Anticipated Speed = 25 MPH				
	Avg Daily Traffic :	Initial Year 2025	VPD 100	Hvy Trucks % 5	Design Year 2055	VPD 200	Hvy Trucks % 5
BRIDGES & STRUCTURES	HIGHWAY, ROAD OR STREET		EXISTING		PROPOSED IMPROVEMENT		
		Surface Type	Width (ft)	Surface Type	Thickness (in)	Width (ft)	Work Type
	Traveled Way:	Concrete	29	Concrete	6	29	3R
	Shoulders:	Concrete	Curbed	Concrete	6	Curbed	
OTHER SCOPE	BRIDGES AND STRUCTURES		EXISTING		PROPOSED IMPROVEMENT		
	Structure Number(s) City/County - NBIS		Structure Type	Condition SR SD FO	Structure Type	Size	Design Loading and Work Type
				____ <input type="checkbox"/> <input type="checkbox"/>			
				____ <input type="checkbox"/> <input type="checkbox"/>			
				____ <input type="checkbox"/> <input type="checkbox"/>			
ANALYSES	Other Scope of Work:		<input type="checkbox"/> Grading <input type="checkbox"/> Acquire Right of Way <input type="checkbox"/> Remove Existing Bridge/Structure				
	<input type="checkbox"/> Add Auxiliary Lane(s)		<input type="checkbox"/> Guardrail <input type="checkbox"/> Other Utilities Work <input type="checkbox"/> Bridge Re-deck				
	<input type="checkbox"/> Sidewalk/Trail		<input type="checkbox"/> Fencing <input type="checkbox"/> Lighting <input type="checkbox"/> Bridge Rail				
	<input type="checkbox"/> Removal of Roadside Obstacles		<input checked="" type="checkbox"/> Curb Work <input type="checkbox"/> Traffic Control Devices <input type="checkbox"/> Storm Sewer or Culverts				
	<input type="checkbox"/> Flatten Vertical Curve(s)		<input type="checkbox"/> Curb Ramp(s) <input type="checkbox"/> Construction Detour <input type="checkbox"/> Erosion Control				
	<input type="checkbox"/> Other: _____						
FINANCIAL	Drainage Study Completed for Structures/Drainage Facilities <input type="checkbox"/> Yes <input type="checkbox"/> Pending <input checked="" type="checkbox"/> N/A				Work/Project Relaxation of Standards Requested <input type="checkbox"/> Yes <input type="checkbox"/> Pending <input checked="" type="checkbox"/> N/A		
	Analyses Completed: <input type="checkbox"/> Yes <input type="checkbox"/> Pending <input checked="" type="checkbox"/> N/A				Other Benefit/Cost Analysis <input type="checkbox"/> Yes <input type="checkbox"/> Pending <input checked="" type="checkbox"/> N/A		
FINANCIAL	Nebraska licensed engineer providing design and construction phases services: <input checked="" type="checkbox"/> Yes <input type="checkbox"/> No						
	Construction Period (estimated): 40.0 working days						
	Other Funds to be Applied:		<input type="checkbox"/> Federal Fund Purchase Program <input type="checkbox"/> State-Aid Bridge Fund <input type="checkbox"/> Federal Funds thru NDOR		<input type="checkbox"/> LB960 County Bridge Match Program <input type="checkbox"/> State Recreation Road Fund <input type="checkbox"/> Other: _____		
FINANCIAL	Estimated Costs (1,000)	County	Municipality	State	Federal	Other	Total
			350				350
FINANCIAL	Print Name: Jeff Wolfe		Title: City Street Superintendent		Date: 11/11/2025		
	Signature: <i>Jeff Wolfe</i>						

One- And Six-Year Plan Highway, Road or Street Improvement Work/Project

GENERAL INFO	Name (County or Municipality): Bayard <input type="checkbox"/> Existing W/P <input checked="" type="checkbox"/> New W/P <input type="checkbox"/> Revision W/P																			
	Work/Project (W/P) Number: M-137 (57)		Work/Project Length: 0.10		miles															
	Other Work/Project Number:				Control Number:															
	Interlocal Agreement: <input type="checkbox"/> Yes <input type="checkbox"/> No If Yes, Name of Other Entity:																			
REVISIONS	Location																			
	Description: 2nd Avenue from 4th Street to 5th Street. Remove and replace pavement, curb, and gutter.																			
STDS	If Revision, describe the changes:																			
	Notification of Revision of One-Year Plan? <input type="checkbox"/> Yes <input type="checkbox"/> No If Yes, what is the reason? <input type="checkbox"/> Revisions to the Work/Project <input type="checkbox"/> Emergency Work/Proj Needed <input type="checkbox"/> Additional Funding Available <input type="checkbox"/> Other: _____																			
TRAFFIC	Functional Class National: Local State: Local																			
	Design Standards Table 2-001. 03. F National Highway System: <input type="checkbox"/> Yes <input checked="" type="checkbox"/> No																			
ROADWAY	Design Speed: 25 MPH Posted/Anticipated Speed = 25 MPH																			
	Avg Daily Traffic : <table border="1" style="display: inline-table; border-collapse: collapse; text-align: center;"> <tr> <td>Initial Year</td> <td>VPD</td> <td>Hvy Trucks %</td> <td>Design Year</td> <td>VPD</td> <td>Hvy Trucks %</td> </tr> <tr> <td>2025</td> <td>100</td> <td>5</td> <td>2055</td> <td>200</td> <td>5</td> </tr> </table>							Initial Year	VPD	Hvy Trucks %	Design Year	VPD	Hvy Trucks %	2025	100	5	2055	200	5	
Initial Year	VPD	Hvy Trucks %	Design Year	VPD	Hvy Trucks %															
2025	100	5	2055	200	5															
BRIDGES & STRUCTURES	HIGHWAY, ROAD OR STREET		EXISTING		PROPOSED IMPROVEMENT															
			Surface Type	Width (ft)	Surface Type	Thickness (in)	Width (ft)	Work Type												
	Traveled Way:	Concrete	34	Concrete	8	34	3R													
Shoulders:	Concrete	Curbed	Concrete	6	Curbed															
OTHER SCOPE	BRIDGES AND STRUCTURES		EXISTING		PROPOSED IMPROVEMENT															
			Structure Number(s)	Structure Type	Condition	Structure Type	Size	Design Loading and Work Type												
	City/County - NBIS		SR SD FO																	
				<input type="checkbox"/>	<input type="checkbox"/>															
				<input type="checkbox"/>	<input type="checkbox"/>															
			<input type="checkbox"/>	<input type="checkbox"/>																
Other Scope of Work: <input type="checkbox"/> Add Auxiliary Lane(s) <input type="checkbox"/> Sidewalk/Trail <input type="checkbox"/> Removal of Roadside Obstacles <input type="checkbox"/> Flatten Vertical Curve(s) <input type="checkbox"/> Other: _____																				
<input type="checkbox"/> Grading <input type="checkbox"/> Guardrail <input type="checkbox"/> Fencing <input type="checkbox"/> Curb Work <input type="checkbox"/> Curb Ramp(s) <input type="checkbox"/> Acquire Right of Way <input type="checkbox"/> Other Utilities Work <input type="checkbox"/> Lighting <input type="checkbox"/> Traffic Control Devices <input type="checkbox"/> Construction Detour <input type="checkbox"/> Remove Existing Bridge/Structure <input type="checkbox"/> Bridge Re-deck <input type="checkbox"/> Bridge Rail <input type="checkbox"/> Storm Sewer or Culverts <input type="checkbox"/> Erosion Control																				
ANALYSES	Drainage Study Completed for Structures/Drainage Facilities <input type="checkbox"/> Yes <input type="checkbox"/> Pending <input checked="" type="checkbox"/> N/A			Work/Project Relaxation of Standards Requested <input type="checkbox"/> Yes <input type="checkbox"/> Pending <input checked="" type="checkbox"/> N/A																
	Analyses Completed: <input type="checkbox"/> Yes <input type="checkbox"/> Pending <input checked="" type="checkbox"/> N/A			Cost Effective Analysis <input type="checkbox"/> Yes <input type="checkbox"/> Pending <input checked="" type="checkbox"/> N/A																
FINANCIAL	Nebraska licensed engineer providing design and construction phases services: <input checked="" type="checkbox"/> Yes <input type="checkbox"/> No																			
	Construction Period (estimated): 20.0 working days																			
	Other Funds to be Applied: <input type="checkbox"/> Federal Fund Purchase Program <input type="checkbox"/> LB960 County Bridge Match Program <input type="checkbox"/> State-Aid Bridge Fund <input type="checkbox"/> State Recreation Road Fund <input type="checkbox"/> Federal Funds thru NDOR <input type="checkbox"/> Other: _____																			
<table border="1" style="width: 100%; border-collapse: collapse; text-align: center;"> <tr> <td>Estimated Costs (1,000)</td> <td>County</td> <td>Municipality</td> <td>State</td> <td>Federal</td> <td>Other</td> <td>Total</td> </tr> <tr> <td></td> <td></td> <td>350</td> <td></td> <td></td> <td></td> <td>350</td> </tr> </table>							Estimated Costs (1,000)	County	Municipality	State	Federal	Other	Total			350				350
Estimated Costs (1,000)	County	Municipality	State	Federal	Other	Total														
		350				350														
Print Name: Jeff Wolfe			Signature: <i>Jeff Wolfe</i>		Title: City Street Superintendent															
					Date: 11/13/2025															

CITY OF BAYARD, NE - 1-6 YR STREET PROGRAM 2026- 2031

1-YEAR STREET PROJECTS

M-137(57) - 2nd Avenue, Pavement
4th Street to 5th Street

6-YEAR STREET PROJECTS

- M-137(36c) - 1st Avenue, Pavement
5th Street to 6th Street
- M-137(7) - Reconstruct Intersections
Ave B & 3rd and Ave B & 4th
- M-137(9) - Curb & Gutter Ave A (2nd to 4th)
Ave B (3rd to 5th)
- M-137(22) - Curb, Gutter, Pavement
3rd Street (Ave A to Ave B)
- M-137(48) - Curb, Gutter, Pavement
13th Street (Main to Ave C)
- M-137(49) - Curb, Gutter, Pavement
14th Street (Main to Ave C)
- M-137(50) - ADA Access (City Wide)
- M-137(51) - Seal Coat Ave A
10th Street to 11th Street
- M-137(53) -Reconstruct 8th Street
Main Street to 1st Avenue
- M-137(54) - Reconstruct Intersection
6th Street & 1st Avenue
- M-137(55) -Reconstruct 5th Street
Avenue A to Avenue B
- M-137(56) -Reconstruct Avenue B
5th Street to 6th Street



M. C. SCHAFF & ASSOCIATES, INC.
818 SOUTH BELTLINE HIGHWAY EAST
SCOTT BLUFF, NEBRASKA 69361

ENGINEERS ♦ PLANNERS ♦ DESIGNERS ♦ LAND SURVEYORS
PH: 308-635-1926 FAX: 308-635-7807 INTERNET: WWW.MCSCHAFF.COM

PROJECT: CITY OF BAYARD
226 TO 2031
STREET PROGRAM

CLIENT: CITY OF BAYARD

PROJECT NUMBER:
RM250001-00

PROJECT DATE:
NOVEMBER 11, 2025

PROJECT MGR:
J.W./M.O.

PROJECT TEAM:

SEAL

DATE	REVISION

SHEET 1 OF 1

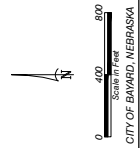

2026 BAYARD 1-6 YR STREET PROGRAM

1YR PROJECTS
6YR PROJECTS

BAYARD
MORRILL COUNTY
NEBRASKA
POPULATION 1,209 (2010 CENSUS)
2014

R 52 W

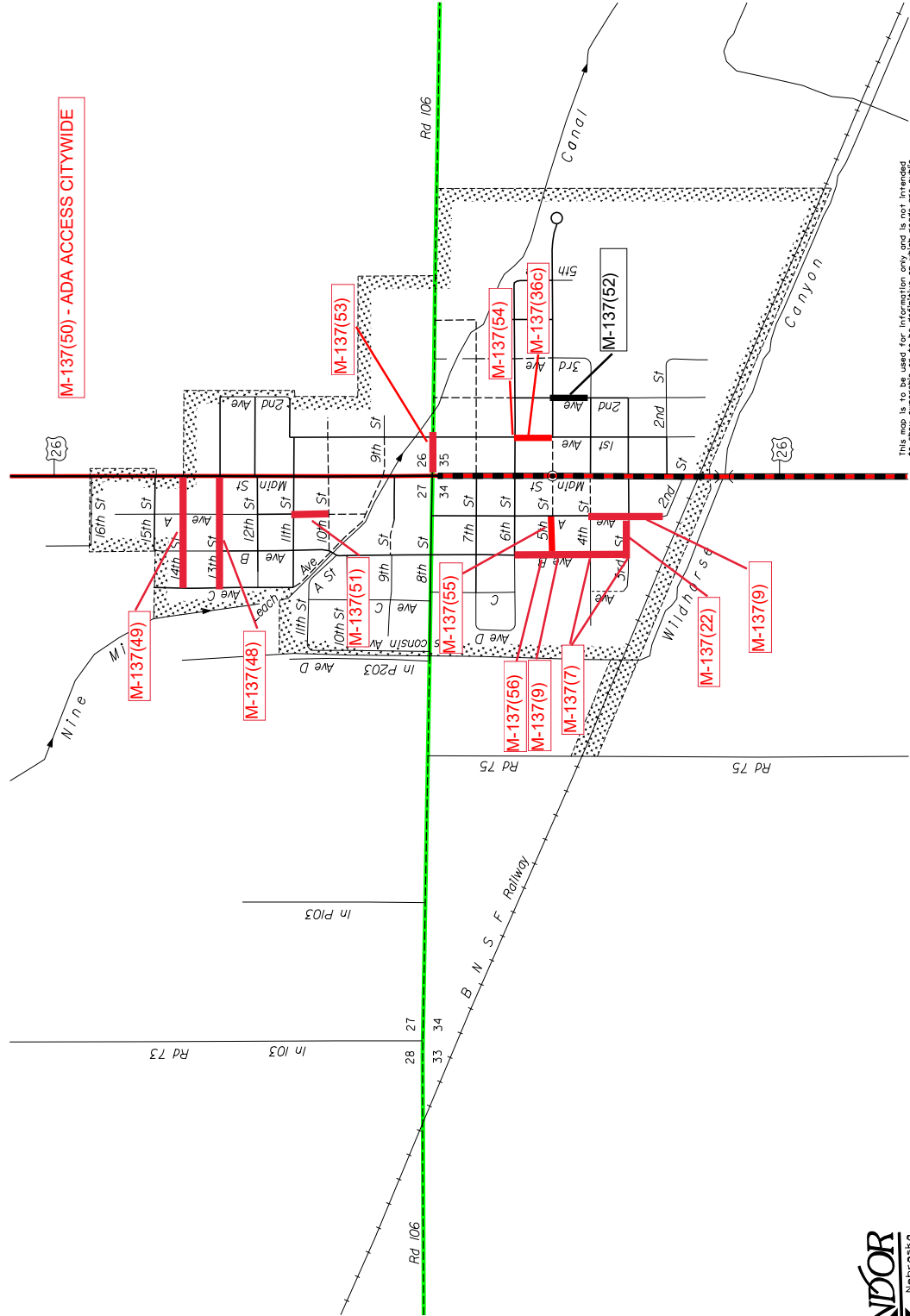

LEGEND

STATE FUNCTIONAL CLASSIFICATION

- INTERSTATE
- EXPRESSWAY
- MAJOR ARTERIAL
- OTHER ARTERIAL
- COLLECTOR
- REMOTE RESIDENTIAL (Rural Only)
- MINIMUM MAINTENANCE (Rural Only)
- SCenic RECREATION (Rural Only)
- UNGRAVISED BOUNDARY

STATE HIGHWAYS

- Gravel or Crushed Rock
- Asphalt/Bituminous Surface
- Multiple Lane Undivided Highway
- Asphalt/Bituminous Surface
- Concrete/Brick Surface
- Multiple Lane Undivided Highway
- Concrete/Brick Surface

CITY STREETS AND COUNTY ROADS

- Primitive or Unimproved
- Gravel or Crushed Rock
- Asphalt/Bituminous Surface
- Concrete/Brick Surface
- Interstate Numbered Routes
- U.S. Numbered Routes
- State Numbered Routes
- State Numbered Spurs
- State Numbered Links
- Main St. Street/Road Names
- City Center
- Corporate Limits

This map is to be used for information only and is not intended to show ownership or to be definitive on which roads are public or private. The engineer has no responsibility for the accuracy of the information shown on this map. Any inaccuracies should be reported to NDOT.



2026 BAYARD 1-6 YR STREET PROGRAM

1YR PROJECTS

6YR PROJECTS

BAYARD
MORRILL COUNTY
NEBRASKA

POPULATION 1,209 (2010 CENSUS)
2014

R 52 W

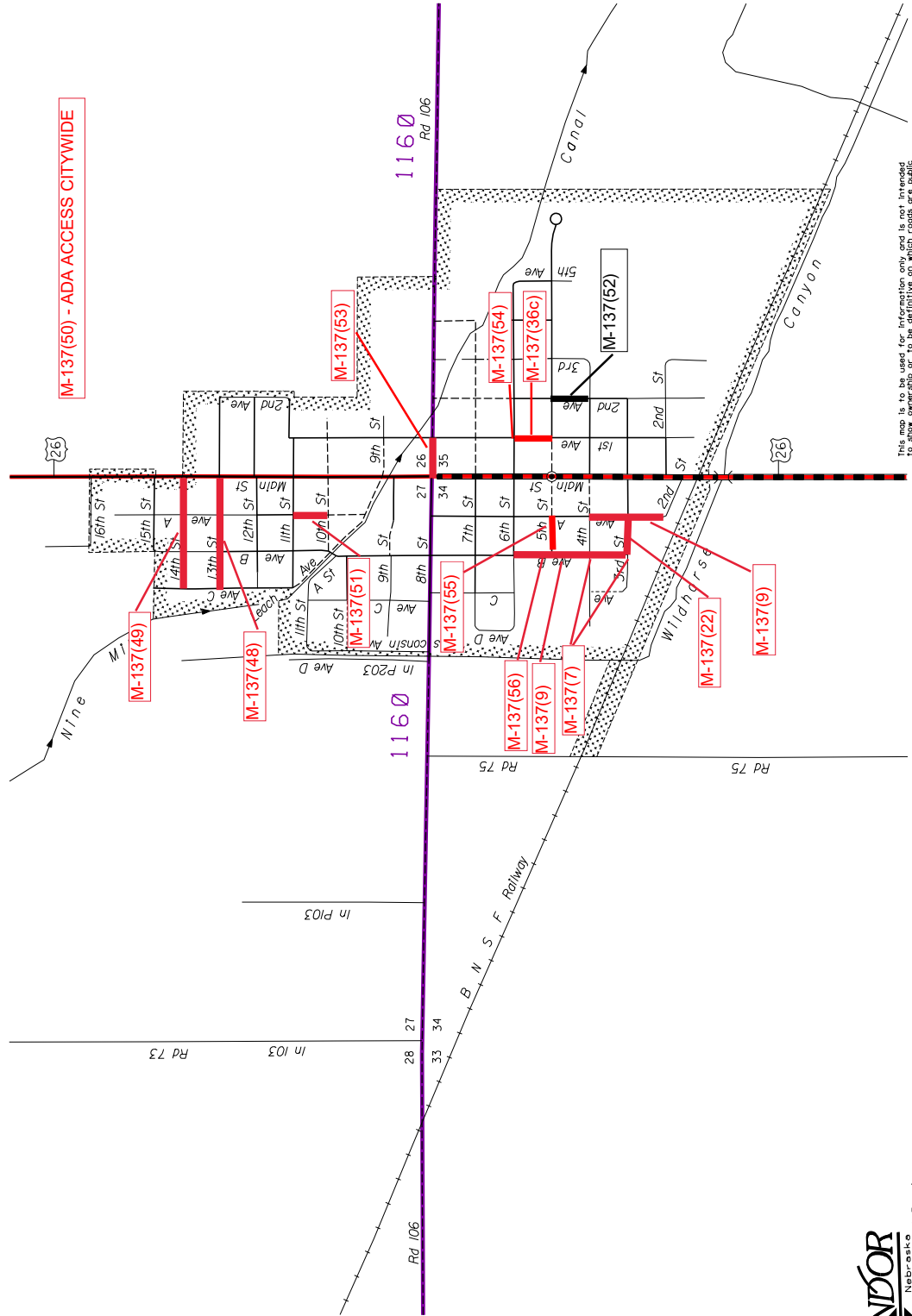

LEGEND

NATIONAL FUNCTIONAL CLASSIFICATION

- INTERSTATE
- OTHER FREeways & EXPRESSWAYS
- STATE ARTERIALS
- MAJOR ARTERIALS
- MAJOR COLLECTOR
- MINOR COLLECTOR
- URBANIZED BOUNDARY

All Roads Not Otherwise Indicated Are Classified As Local.

STATE HIGHWAYS

- Gravel or Crushed Rock
- Asphalt/Bituminous Surface
- Multiple Lane Undivided Highway
- Asphalt/Bituminous Surface
- Concrete/Brick Surface
- Multiple Lane Undivided Highway
- Concrete/Brick Surface

CITY STREETS AND COUNTY ROADS

- Primitive or Unimproved
- Gravel or Crushed Rock
- Asphalt/Bituminous Surface
- Concrete/Brick Surface

Interstate Numbered Routes

- U.S. Numbered Routes
- State Numbered Routes
- State Numbered Spurs
- State Numbered Links

Main St Street/Road Names

- City Center
- Corporate Limits

This map is to be used for information only and is not intended to constitute a contract. The Nebraska Department of Roads makes no warranties, guarantees or representations for the accuracy of the information shown on this map. Any inconsistencies should be reported to NDR.

